

DRY-RIGHT II™

# Water Control System

Complete Basement Water Control

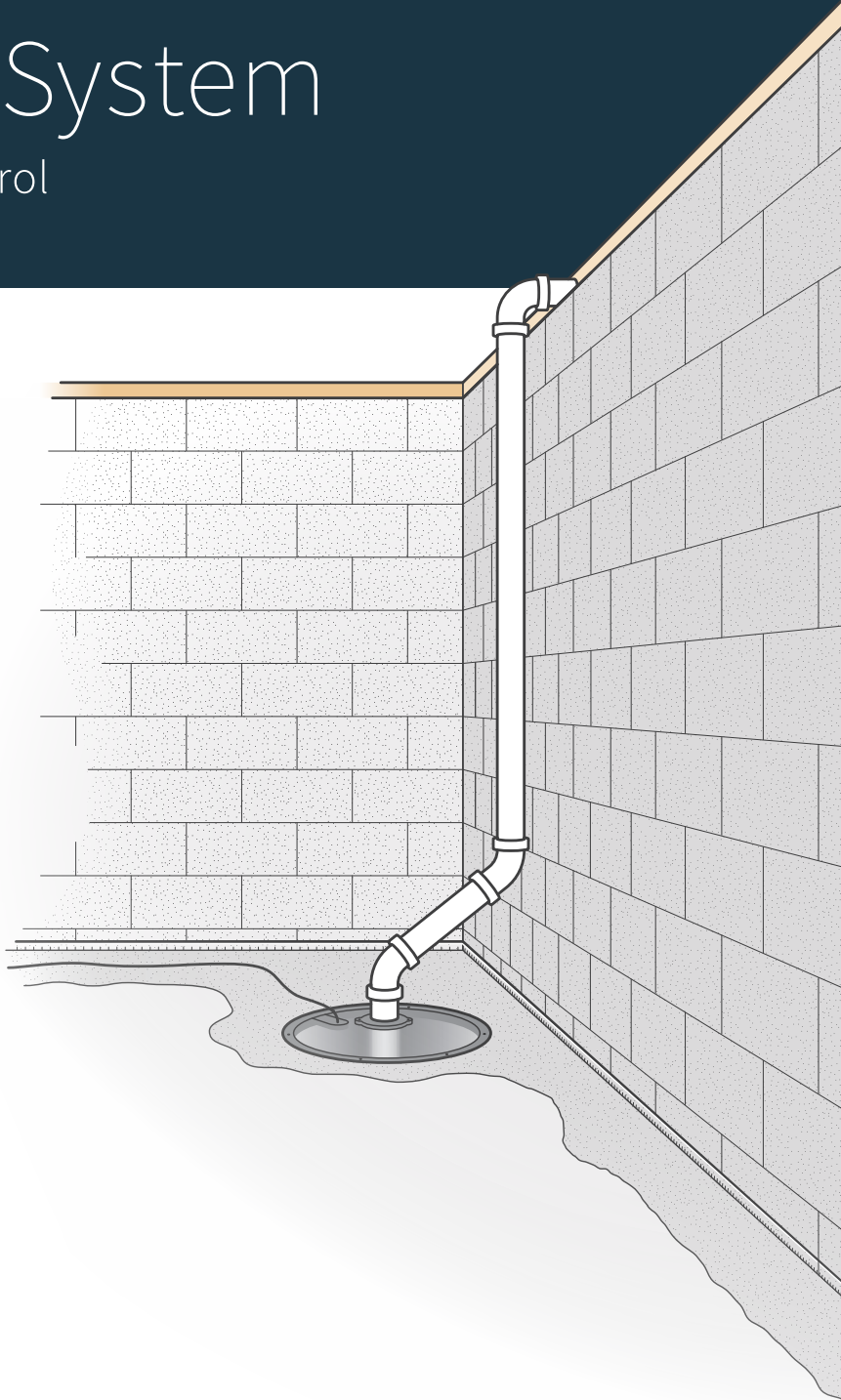

# Why Choose the ABT Dry-Right II™ Water Control System?

Depending on when your home was built, there may have been a drainage system installed around the foundation called drain tile. As water from rain, ground water, and melting snow accumulated around your foundation, it ran into the drain tile and drained into the ground, floor drain, or into a sump system in your basement.

If you are getting water on your basement floor, seeping through the walls, dampness, staining and efflorescence (white powder), most likely your drain tile is plugged or you may not have any. Over the years, dirt, tree roots and other debris clog the drain tile and prevent it from functioning properly. One solution to this problem is to install a new drainage system.

There are two rules of water control:

- Water seeks the path of least resistance
- Water seeks its own level

ABT controls the water by:

- Creating a path of least resistance to drainage.
- Installing a solution where the water remains below your basement floor.

The ABT Dry-Right II™ Water Control System obeys both rules of water and creates a dry and comfortable environment for your home without compromising the integrity of your foundation. By installing an ABT Dry-Right II Water System inside your basement, you can have a dry basement with no exterior digging.

## WE FIX BAD BASEMENTS... RIGHT!

It's not just a slogan, we actually fix basements right, so the first time is the last time. Other companies may offer to replace your drain tile at a lower cost. Here is how we do it right:

### DEEPER IS BETTER (Fig. 1)

ABT's Dry-Right II Water Channel is positioned correctly next to the foundation footing, so water is drained away before it reaches your basement floor. Some companies put the new water channel on top of the footing which allows water to rise to the bottom of your basement floor.

It is less expensive to put the channel on top of the footing because the trench is shallower and less material is removed.

According to the Builder's Foundation Handbook produced by Oak Ridge National Laboratory for the U.S.

Department of Energy, "Components of a subsurface system can include porous backfill, drainage mat materials or insulated drainage boards, and perforated drain pipes in a gravel bed along the footing or beneath the slab that drain to a sump or to daylight."

- A* Water Channel
- B* Concrete Slab
- C* Footing
- D* Dimple Sheet Drain
- E* Wall
- F* Exterior
- G* Replaced Concrete Slab

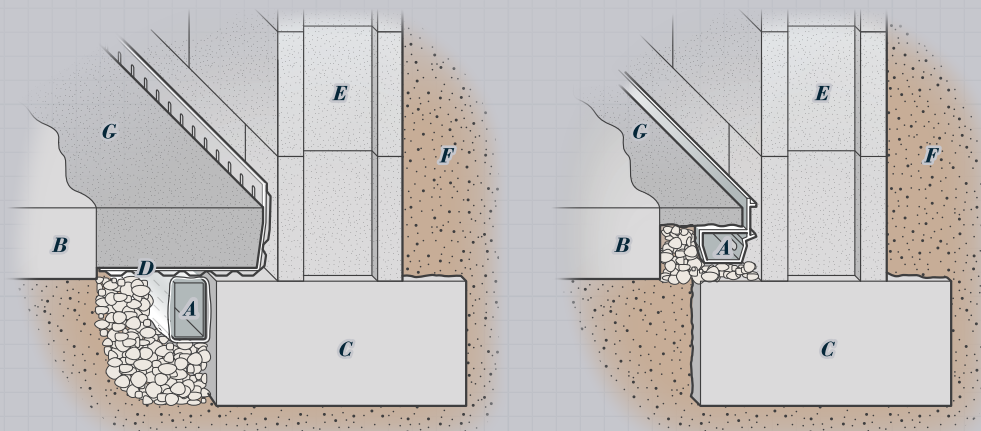
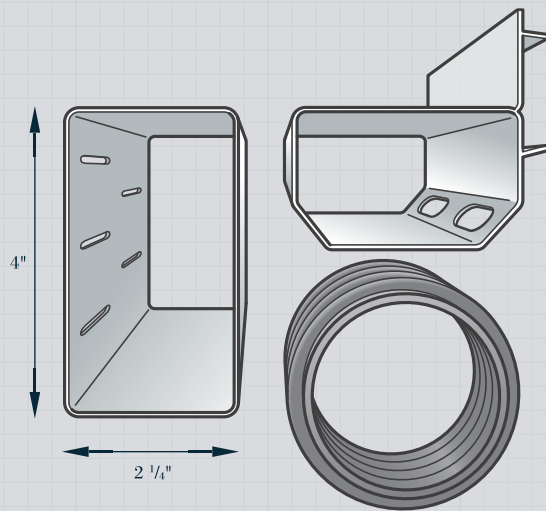
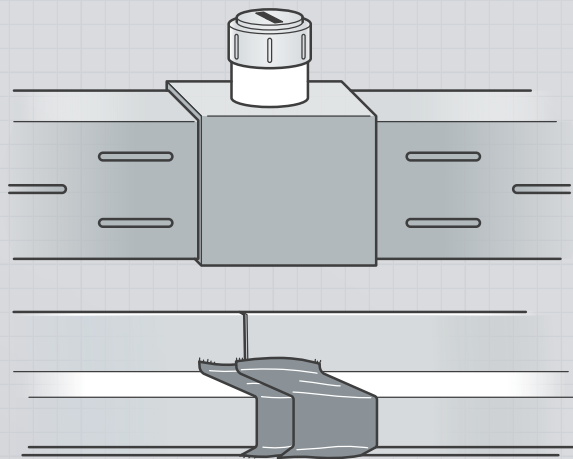

Figure 1 — Water Channel Position



**Figure 2** — Water Channel Volume



**Figure 3** — Water Channel Segment Connection

### THE HEART OF YOUR SYSTEM (Fig. 5)

ABT Dry-Right II Sump Systems are specifically designed to work with new drain tile, and ensure maximum protection for your home. If your current sump pump runs frequently, your sump may be too small to efficiently remove the excess water around your basement. Running frequently can also lead to premature pump failure.

The perforated, patented “bell-shaped” design of the ABT Dry-Right II Sump System allows more water into the basin before the pump is activated.

#### system also features

- Energy efficient 3,000 gallons/hour pump
- Clear lid, radon approved
- Stainless steel hardware
- Water level alarm
- Thermal protection switch (prevents overheating)
- Three year manufacturer’s warranty

### BIGGER IS BETTER (Fig. 2)

ABT’s Dry-Right II Water Channel is larger to allow maximum drainage and reduce clogging.

### LOCKING IS BETTER (Fig. 3)

ABT’s Dry-Right II Water Channel sections lock together to form a strong continuous drain. Others are simply taped together.

### SERVICEABLE IS BETTER

Inspection ports allow access to the system and permit flushing if necessary.

### COVERED IS BETTER (Fig. 4)

ABT’s Dry-Right II Water Channel is covered with a fabric sock to reduce dirt and debris from entering and clogging. Since it is entirely surrounded by clean gravel there is no direct contact with dirt or mud.

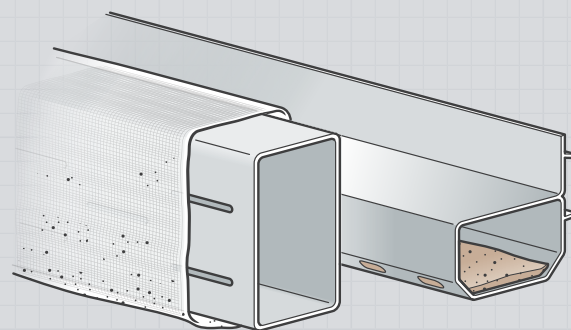

**Figure 4** — Water Channel Debris Filtering

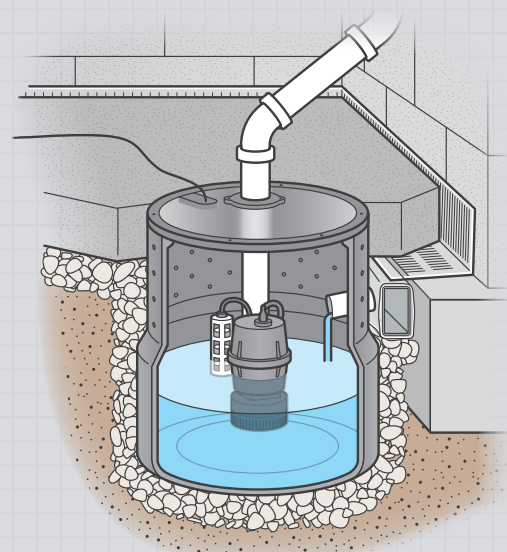

**Figure 5** — Sump System

# The Installation Process

---

## INTRODUCTION

Your ABT crew arrives and the foreman will introduce himself. He will have you show him to your basement and confirm the work area.

---

## PROTECTION

The crew will cover carpet and flooring in work area, if needed.

---

## EXCAVATION

Concrete will be removed with jackhammers. We do our best to minimize dust, but there will be some. The rubble that is removed is carried out to our truck for disposal. A trench is dug down next to the footing and clean gravel is put in. A hole is dug for the ABT Dry-Right II Sump System (*if part of contract*).

---

## INSTALLATION

ABT Dry-Right II Water Channel is laid in the trench next to the footing and is connected to the sump. ABT Dry-Right II Cove Base is laid where the floor meets the wall on top of the footing. Inspection ports are inserted into the ABT Dry-Right II Water System.

Additional gravel is laid around the ABT Dry-Right II Water System as needed. Plastic vapor barrier is laid over the ABT Dry-Right II Water System. Then, concrete is carried into the basement and poured into the trench. The concrete is carefully troweled over the trench to match with the existing floor as closely as possible.

---

## CLEAN-UP

All tools are removed and the work area is swept clean.

**HAVE PEACE OF MIND KNOWING YOUR BASEMENT IS PROPERLY REPAIRED AND IS ONCE AGAIN SAFE AND SECURE!**

**ABT**

**FOUNDATION  
SOLUTIONS**

8718 STATE ROAD 76  
NEENAH, WI 54956-9503

**TOLL-FREE** 1 (800) 967-4ABT (4228)  
**APPLETON** (920) 733-4ABT (4228)  
**GREEN BAY** (920) 435-4ABT (4228)  
**MADISON** (608) 350-1111  
**ONLINE** WWW.CALLABT.COM